

Installation Guide

Terminating GigaFlex Modules

Version 03.00 2007 1 of 2 pages

PX101565E

BELDEN

1

Cable preparation

1. Cut off approx. a 2" (5 cm) portion of jacket



2. Slit jacket approx. 4" (10 cm) with ripcord, or use a standard slitting tool

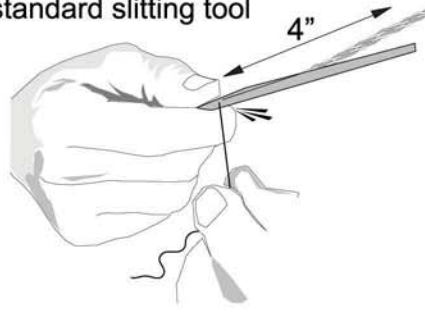

3. Cut off ripcord (and cross-web, if applicable) **Do not trim jacket!**

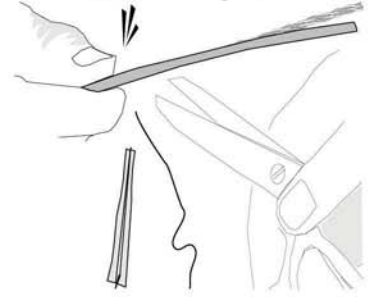

2

Peel back jacket, spread and form pairs into a quadrant according to color code, shown below

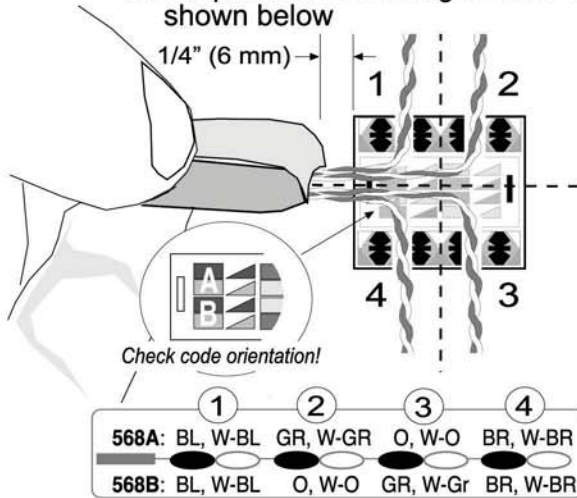

3

Position and insert each wire as per color code *Use pair splitters to separate pairs*

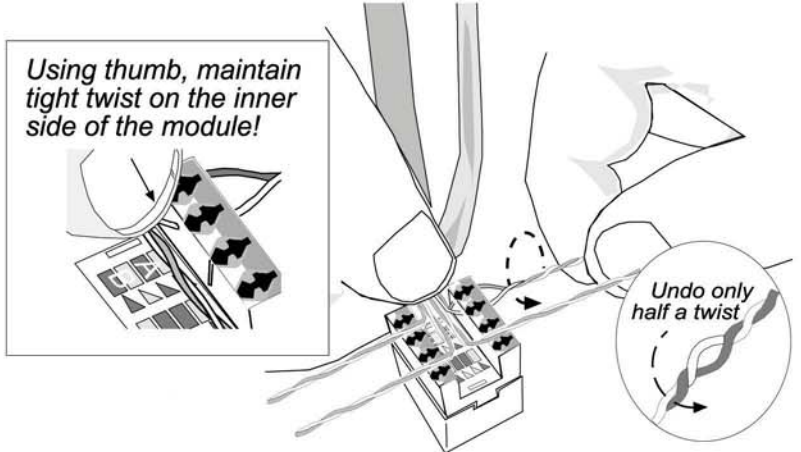

4

Prepare for termination by supporting assembly on a hard flat surface

Tip! For extra stability, we suggest using the hand-held Termination Station (part # AX101172), shown below

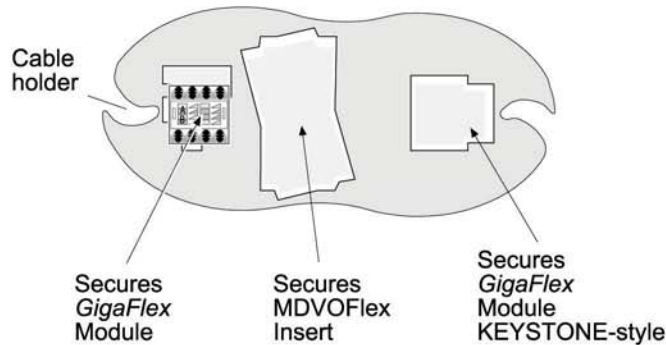

5

Before terminating, dress cable jacket onto center channel of module to protect wires

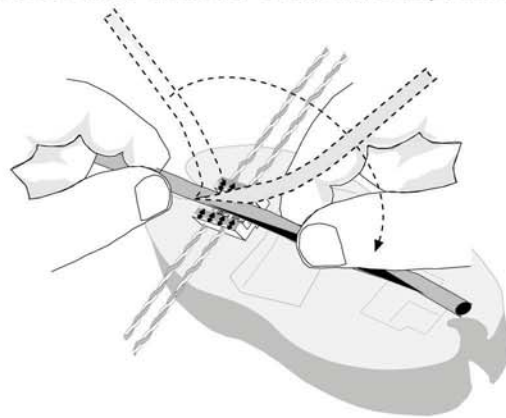

6 Termination

Hold tool perpendicular to module and terminate
Cutting edge on outer side of module!

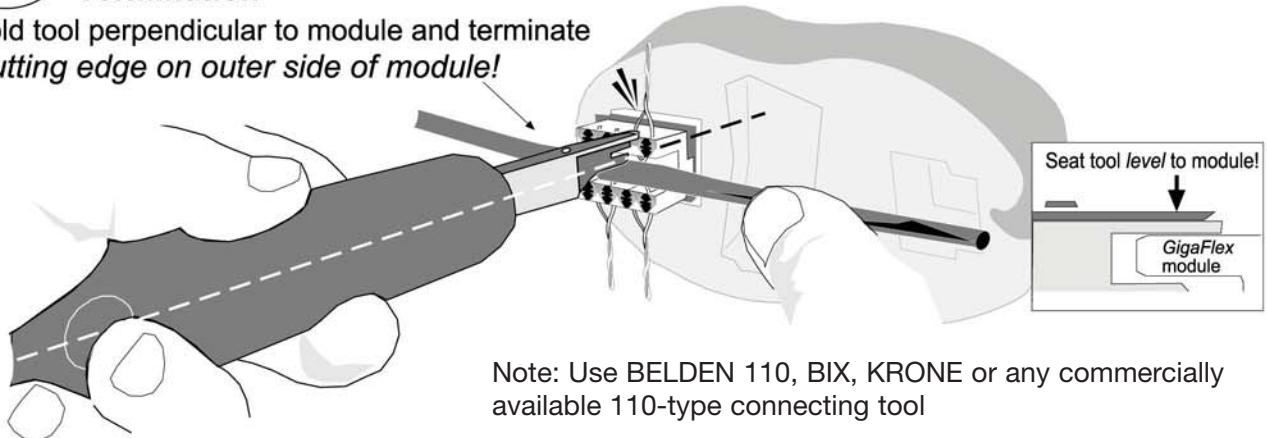

Note: Use BELDEN 110, BIX, KRONE or any commercially available 110-type connecting tool

7 Trim off excess jacket

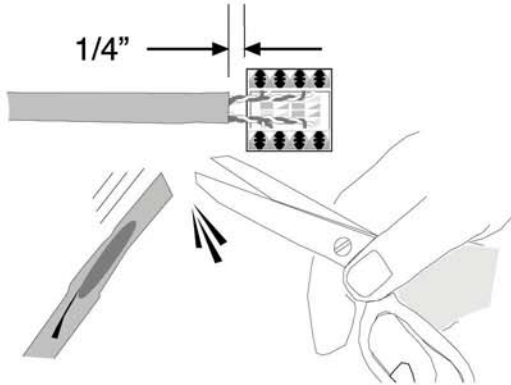

8

1. Press protective cap onto top of module, until it *snaps!*

2. Rotate cable into slot in cap

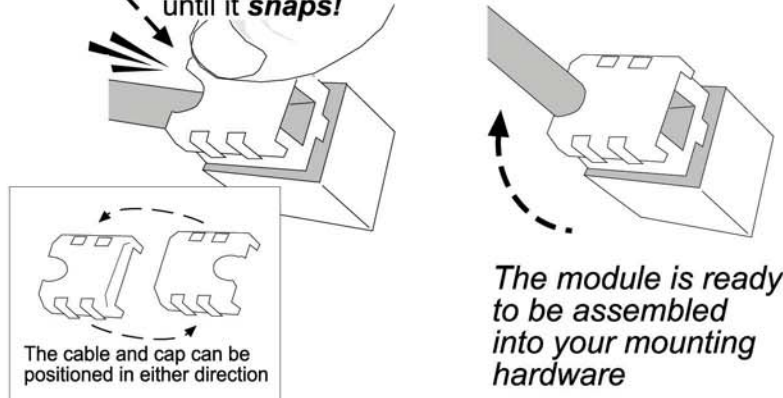

Removing modules from mounting hardware

1. Push front of the module inwards with thumb, while releasing hooks

2. Wedge tool to release upper hook

3. Wedge tool to release lower hook

Use..



AX101185

..or..

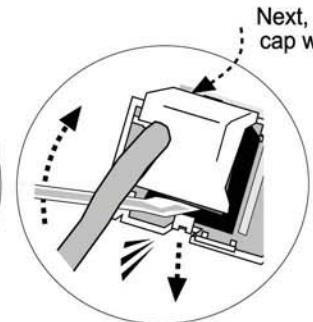
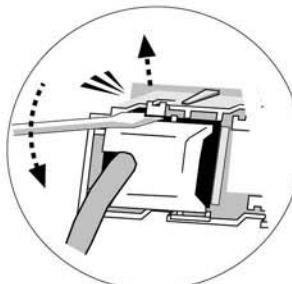
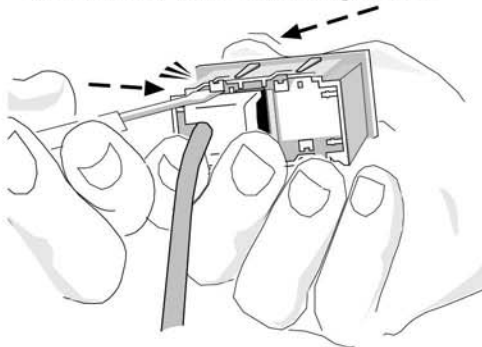

BELDEN

For additional technical information on GigaFlex Modules or our other connecting products, call 1-800-858-7954

© 1996, 2007 Belden, Inc.