

Installation Guide

GigaBIX Cross-Connect System

Version 03.00 2007 PX103648

GigaBIX

1 of 1 pages

GigaBIX Ring Spacer (Cross-Connect Layout)

Accessory & Components

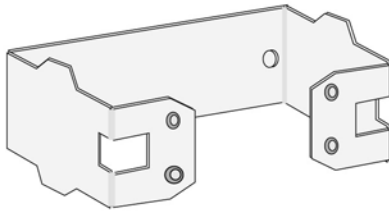

GigaBIX Ring Spacer : AX102190
Quantity: 1

Machine Screws
#10-32
Quantity: 4

Related Documents

GigaBIX Termination Kit,
72 Port: - Doc # PX101814
GigaBIX Termination Kit,
300 Pair: - Doc # PX101821
GigaBIX Patch Cord
Organizers: - Doc # PX101877
GigaBIX Horizontal Channel
Plates: - Doc # PX101878

Wood Screws
#8-3/4"
Quantity: 2

Refer to the documents above
for full details on standardized
GigaBIX installation methods.

Note: All of the necessary modules are installed
before cables are routed.
Additional hardware is added after cable routing.

1. Attaching The Ring Spacer In A Horizontal Position



1.1. Position Ring Spacer
under tab on Cable
Management Module.

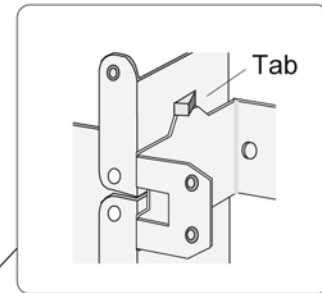

1.2. Fasten
Ring Spacer
onto backboard
using the two
wood screws.



1.3. Align adjacent modules for correct
horizontal and vertical positioning.

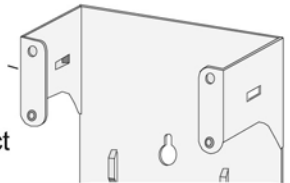

2. Attaching the Spacer In A Vertical Position

2.1. Using the four
machine screws,
attach a Distribution
Ring to the Ring
Spacer.

2.2. Attach the GigaBIX Mount to the Cable
Management Module.

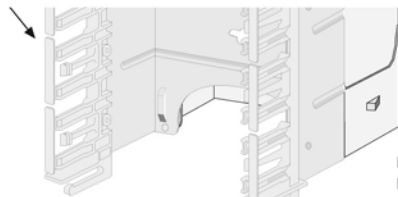

2.3. Attach
Distribution
Ring and
Ring Spacer
Assembly
to GigaBIX
Mount.

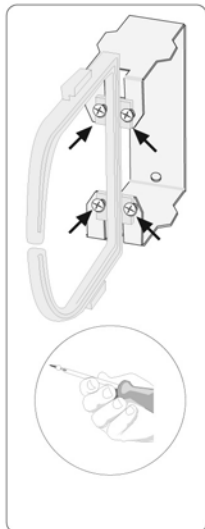

2.4. Secure the Ring Spacer to
the backboard with the two wood screws.

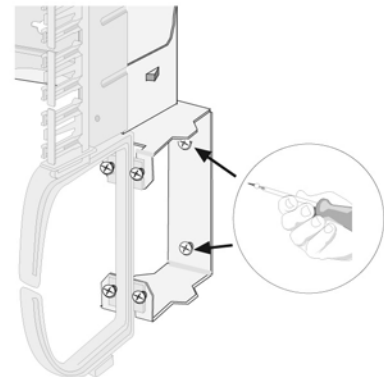

For additional technical information
on GigaBIX or our other connectivity
products, call 1-800-858-7954

© 1996, 2007 Belden, Inc. Printed in Canada

BELDEN